

MISTER REPLACEMENT

TO REDUCE THE RISK OF FIRE, ELECTRIC SHOCK, OR INJURY TO PERSONS, OBSERVE THE FOLLOWING:

- ⚠ **WARNING: ELECTRICAL SHOCK HAZARD.** Disconnect the power supply before performing service or maintenance. Failure to do so may result in serious injury or death.
- ⚠ **WARNING:** Make sure casters are locked before performing service or maintenance.
- ⚠ **WARNING:** When service or replacement of a component in the fan requires the removal or disconnection of a safety device, the safety device is to be reinstalled or remounted as previously installed.
- ⚠ **CAUTION:** The Big Ass Fans product warranty will not cover equipment damage or failure that is caused by improper installation or use.

1. Drain reservoir and remove access panel

Remove drain plug from bottom of fan (*Fig. 1*). Allow water to drain, and then reinstall drain plug. **Do not tilt fan to remove or reinstall drain plug.** Remove reservoir access panel from front of fan (eight screws and washers, *Fig. 1*). **Save screws and washers for reinstallation.**

Fig. 1

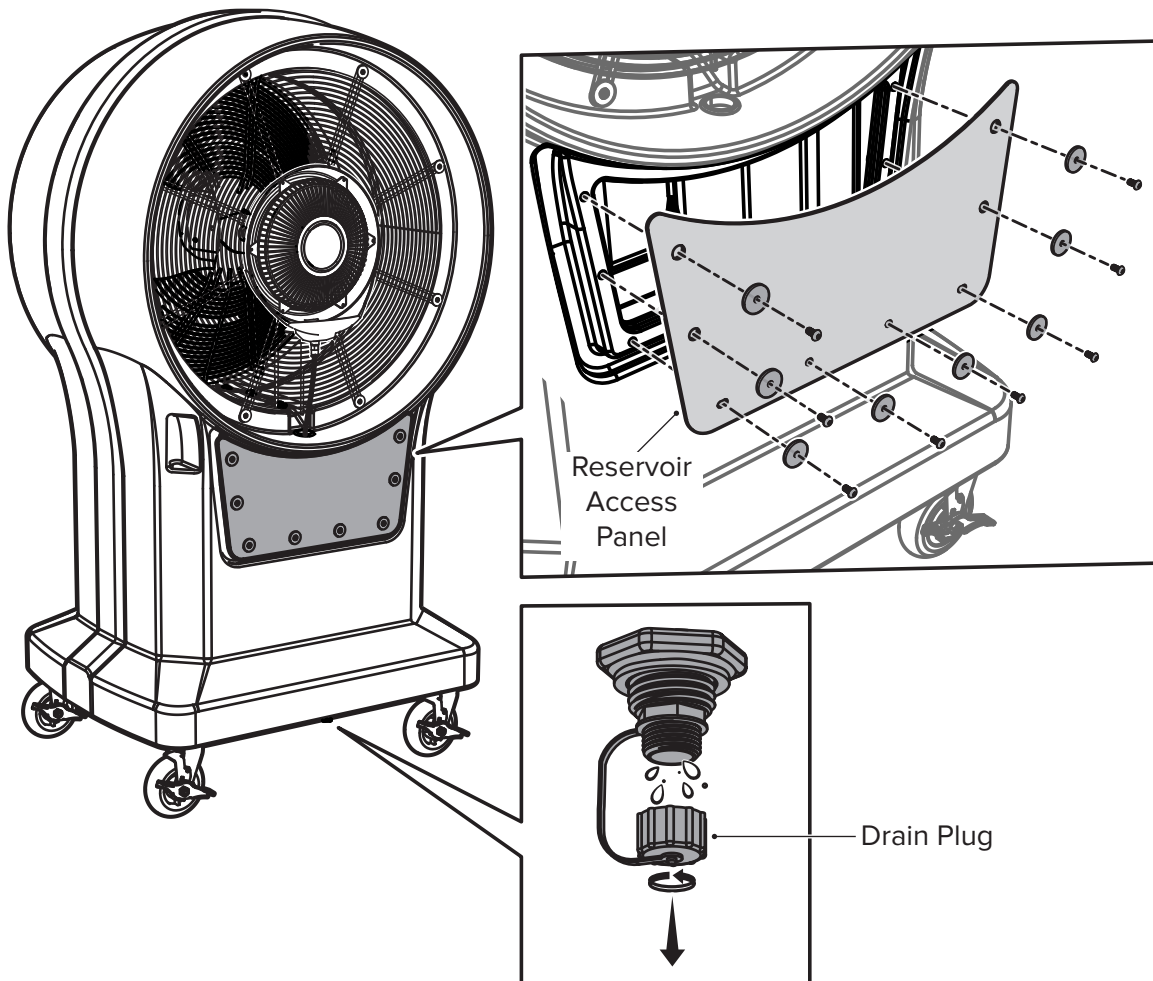

MISTER REPLACEMENT

2. Disconnect mister wiring harnesses and water lines

Disconnect four-pin mister wiring harness from four-pin harness inside access panel opening (Fig. 2.1). Locate pump assembly at bottom of reservoir. Note its location and orientation for reinstallation (Fig. 2.2).

Carefully lift pump assembly out of access panel opening and allow to hang out of opening (Fig. 2.3). Cut zip tie securing filter bag around pump assembly. Remove filter bag and **save for reinstallation**. Disconnect water supply line from top of pump assembly by pushing in on line and then pulling line out of pump fitting (Fig. 2.4).

Fig. 2.1: Disconnect wiring harnesses

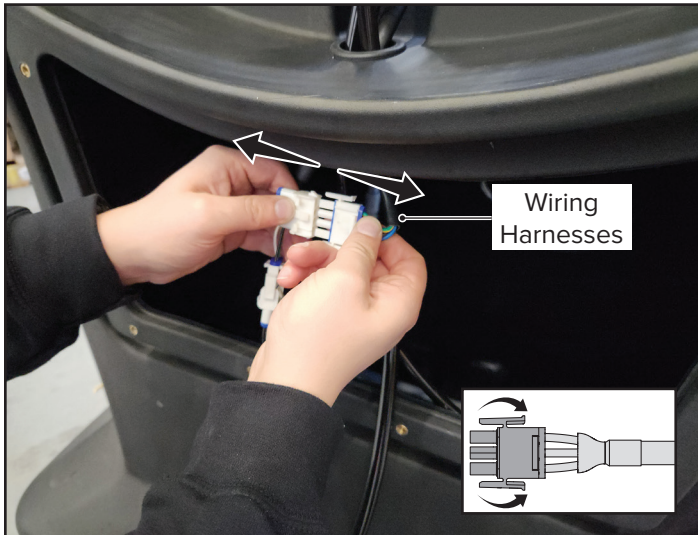

Fig. 2.2: Locate pump assembly



Fig. 2.3: Remove pump assembly



Fig. 2.4: Disconnect supply line

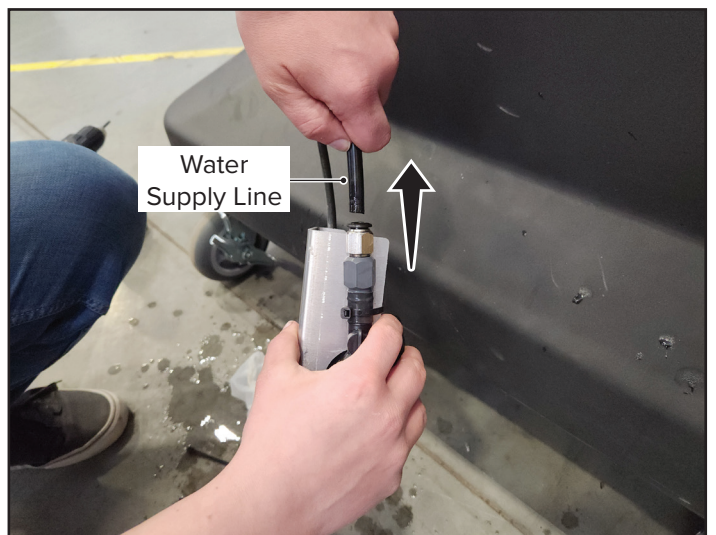

MISTER REPLACEMENT

Remove zip tie securing mister drain line to water supply line (Fig. 2.5). Disconnect drain line from bottom of mister by pushing in on line and then pulling line out of fitting (Fig. 2.6). **Save drain line for reinstallation.**

Pull four-pin mister power cable up and out of reservoir through cable hole (Fig. 2.7). Disconnect three-pin pump/mister wiring harness from pump assembly wiring harness inside access panel opening (Fig. 2.8). **Set disconnected pump assembly aside in a safe location for reinstallation.**

Fig. 2.5: Remove drain line zip tie

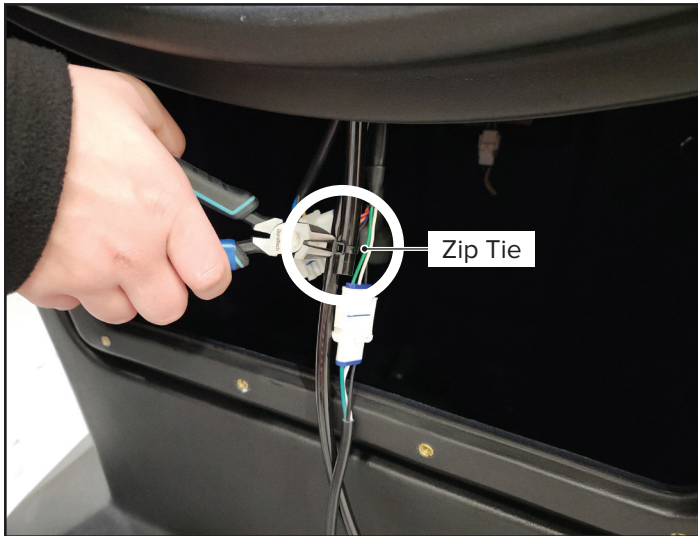

Fig. 2.6 Disconnect and save drain line

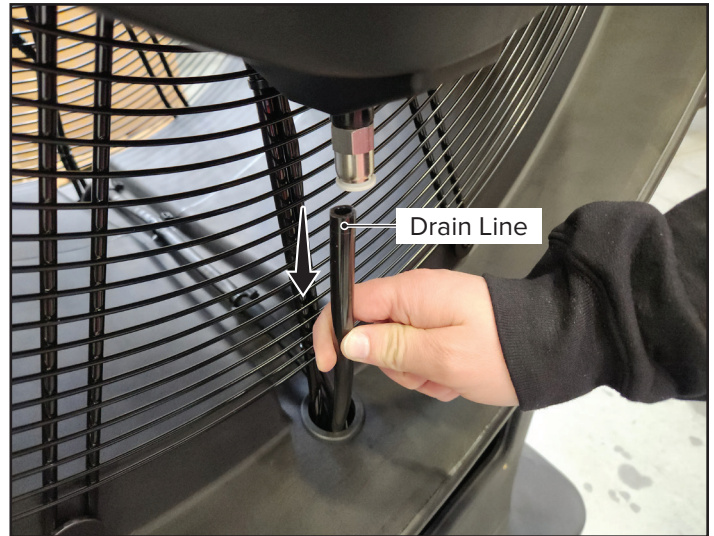

Fig. 2.7: Pull mister cable out of reservoir

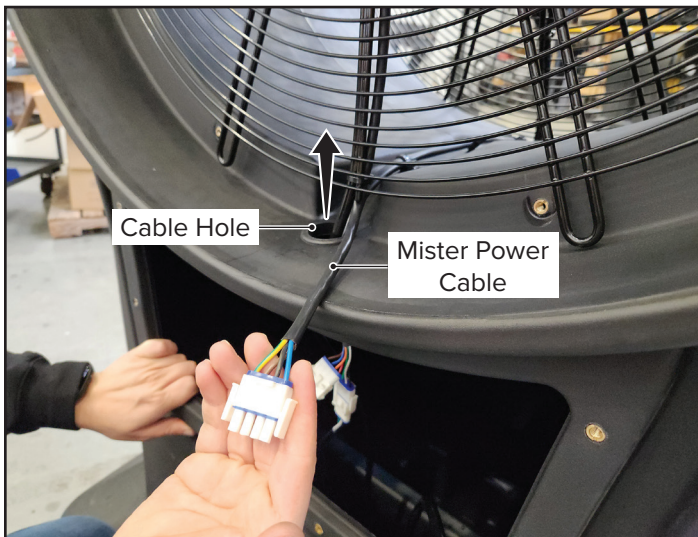
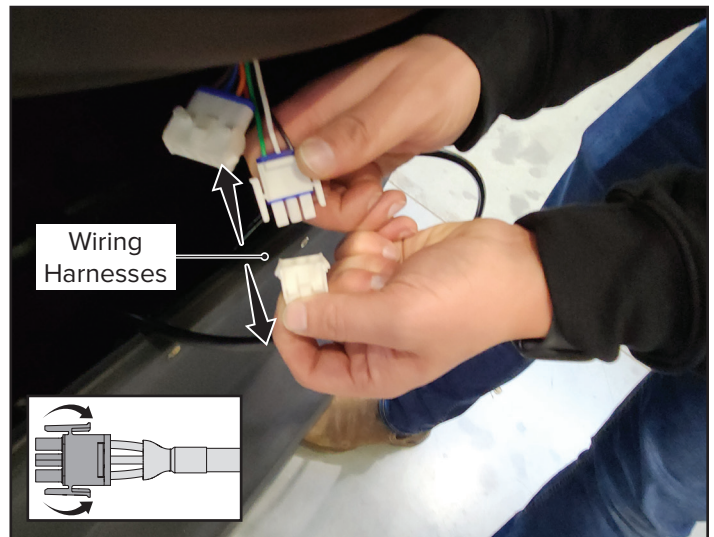

Fig. 2.8: Disconnect wiring harnesses



MISTER REPLACEMENT

3. Remove front guard/mister assembly



Front guard/mister assembly is heavy. Two people are recommended for this step.

Remove seven of the eight front guard screws and washers, leaving one top screw and washer loosely in place (Fig. 3.1). **While supporting front guard/mister assembly** (two people recommended), remove remaining screw and washer, and then remove front guard/mister assembly from fan housing (Fig. 3.2). **Save screws and washers for reinstallation.**

Fig. 3.1



Fig. 3.2



4. Disassemble front guard/mister assembly

Place front guard/mister assembly mister-side down on a flat working surface. Note location of the two zip ties securing mister water supply line and power cable to front guard, and then remove the zip ties (Fig. 4.1). Disconnect water supply line from back of mister by pushing in on line and then pulling line out of fitting (Fig. 4.2). **Save supply line for installation on new mister.**

Remove **and discard** the four screws securing front guard to mister (Fig. 4.3). Remove front guard from back of mister (Fig. 4.4).

Fig. 4.1: Remove zip ties

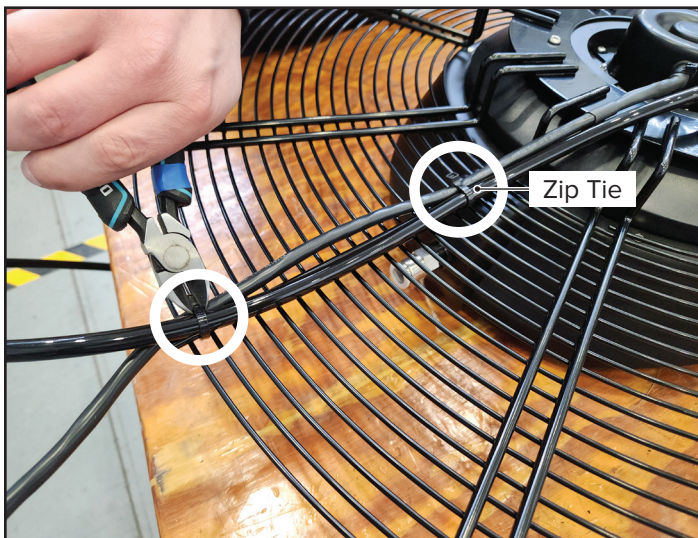

Fig. 4.2: Disconnect and save supply line



Fig. 4.3: Remove and discard screws



Fig. 4.4: Remove front guard from mister



MISTER REPLACEMENT

5. Install new mister

Place new mister face down on a flat working surface. Align screw holes on front guard with screw holes on back of mister, and **make sure supply fitting is centered inside cutout on front guard** (Fig. 5.1). Secure front guard to mister with the four provided screws and tighten to **35 in-lb (4 N-m)** (Fig. 5.2).

Connect water supply line from old mister to new mister by pushing line into fitting (Fig. 5.3). Secure water supply line and power cable to vertical bar on front guard with zip ties in same locations as original zip ties (Fig. 5.4). Trim zip ties.

Fig. 5.1: Align front guard and mister



Fig. 5.2: Secure front guard to mister



Fig. 5.3: Connect supply line



Fig. 5.4: Secure supply line and power cable

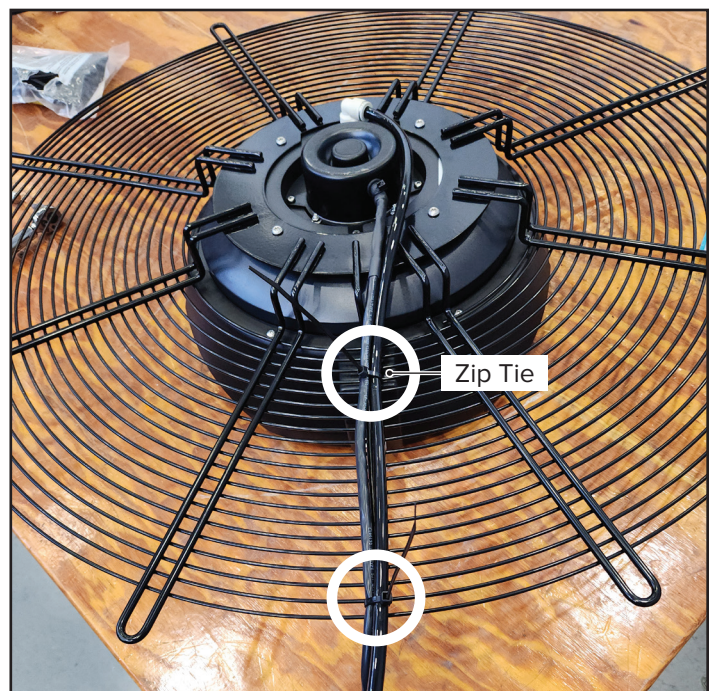

6. Reinstall front guard/mister assembly



Front guard/mister assembly is heavy. Two people are recommended for this step.

While supporting front guard/mister assembly (two people recommended), loosely reinstall assembly to fan housing with one top screw and washer (Fig. 6.1), and then loosely install remaining seven screws and washers. After all screws are loosely installed, tighten to 30 in-lb (3.4 N-m) (Fig. 6.2).

Fig. 6.1



Fig. 6.2

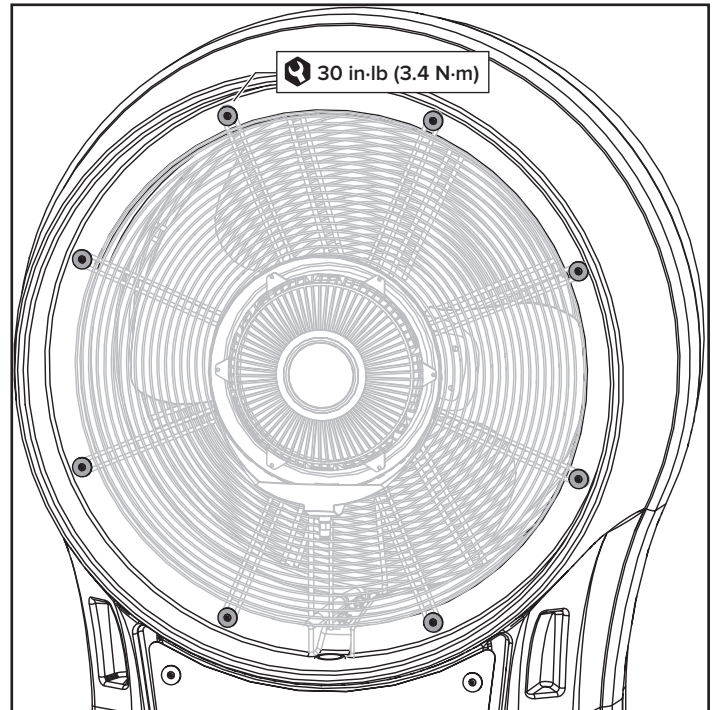

7. Connect wiring harnesses and water lines

Route mister power cable (Fig. 7.1) and water supply line (Fig. 7.2) into reservoir through cable hole.

Connect mister wiring harness to four-pin pump/mister cable harness inside access panel opening (Fig. 7.3).

Rest pump assembly on the ground next to unit. Connect three-pin pump/mister wiring harness to pump assembly wiring harness (Fig. 7.4).

Connect saved drain line to bottom of mister by pushing line into fitting (Fig. 7.5). Route drain line into reservoir through cable hole and secure to water supply line with a zip tie (Fig. 7.6).

MISTER REPLACEMENT

Fig. 7.1: Route mister cable into reservoir

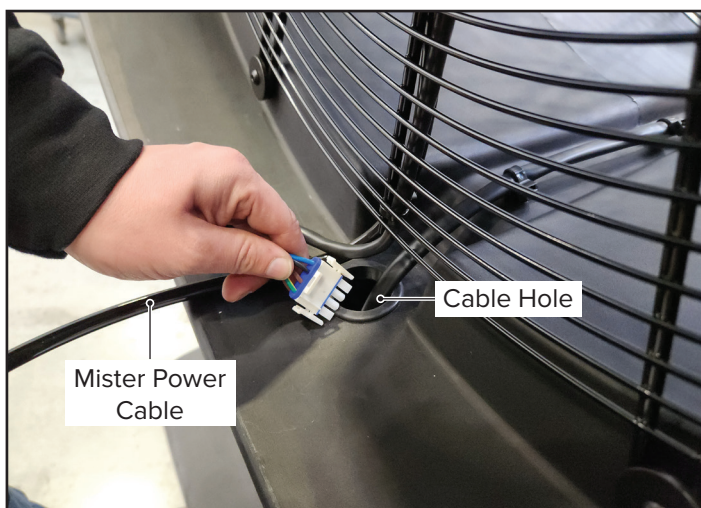

Fig. 7.2: Route supply line into reservoir



Fig. 7.3: Connect wiring harnesses

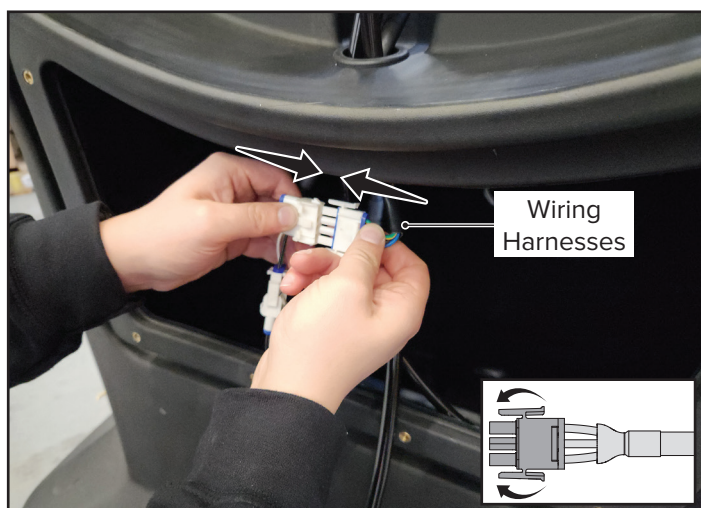

Fig. 7.4: Connect wiring harnesses

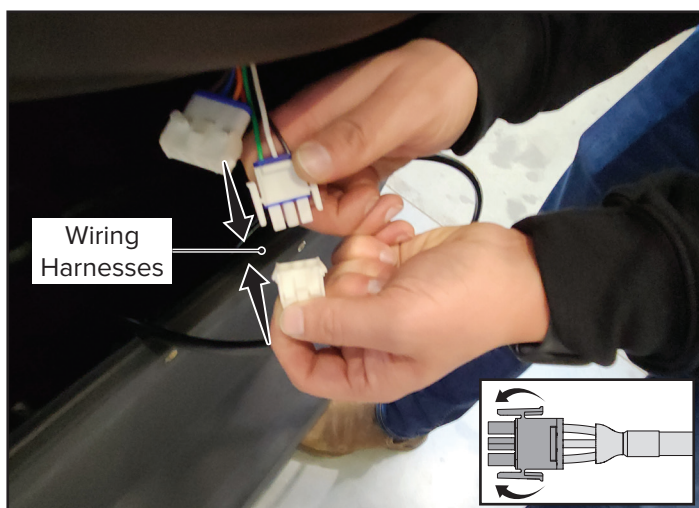
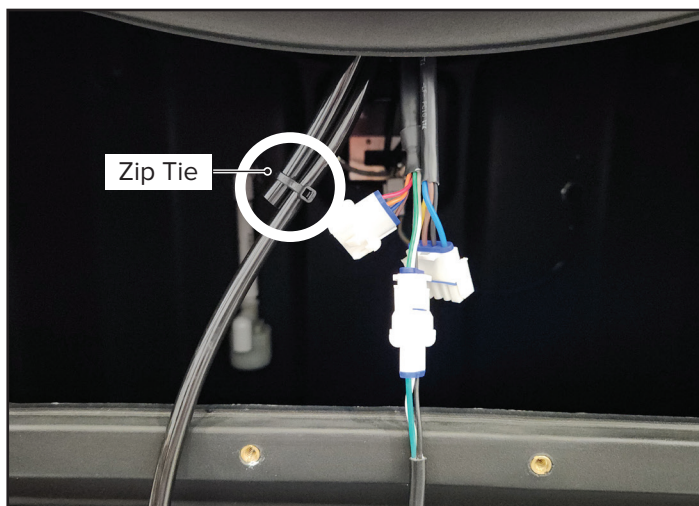

Fig. 7.5: Connect drain line to mister



Fig. 7.6: Secure water lines



8. Reinstall pump assembly and access panel

Connect water supply line to pump assembly by pushing line into fitting on top of pump (Fig. 8.1). Secure filter bag around pump assembly with a zip tie. Place pump assembly into reservoir in the location shown and make sure pump is sitting level (Fig. 8.2).

Reinstall reservoir access panel and torque the eight screws to **30 in-lb (3.4 N·m)** (Fig. 8.3).

Fig. 8.1

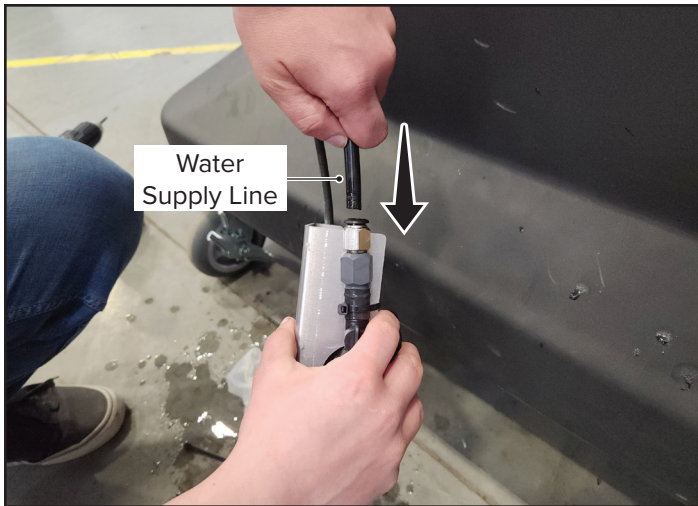

Fig. 8.2



Fig. 8.3

