

PUMP REPLACEMENT

TO REDUCE THE RISK OF FIRE, ELECTRIC SHOCK, OR INJURY TO PERSONS, OBSERVE THE FOLLOWING:

- ⚠ **WARNING: ELECTRICAL SHOCK HAZARD.** Disconnect the power supply before performing service or maintenance. Failure to do so may result in serious injury or death.
- ⚠ **WARNING:** Make sure casters are locked before performing service or maintenance.
- ⚠ **WARNING:** When service or replacement of a component in the fan requires the removal or disconnection of a safety device, the safety device is to be reinstalled or remounted as previously installed.
- ⚠ **CAUTION:** The Big Ass Fans product warranty will not cover equipment damage or failure that is caused by improper installation or use.

1. Drain reservoir and remove access panel

Remove drain plug from bottom of fan (*Fig. 1*). Allow water to drain, and then reinstall drain plug. **Do not tilt fan to remove or reinstall drain plug.** Remove reservoir access panel from front of fan (eight screws and washers, *Fig. 1*). **Save screws and washers for reinstallation.**

Fig. 1

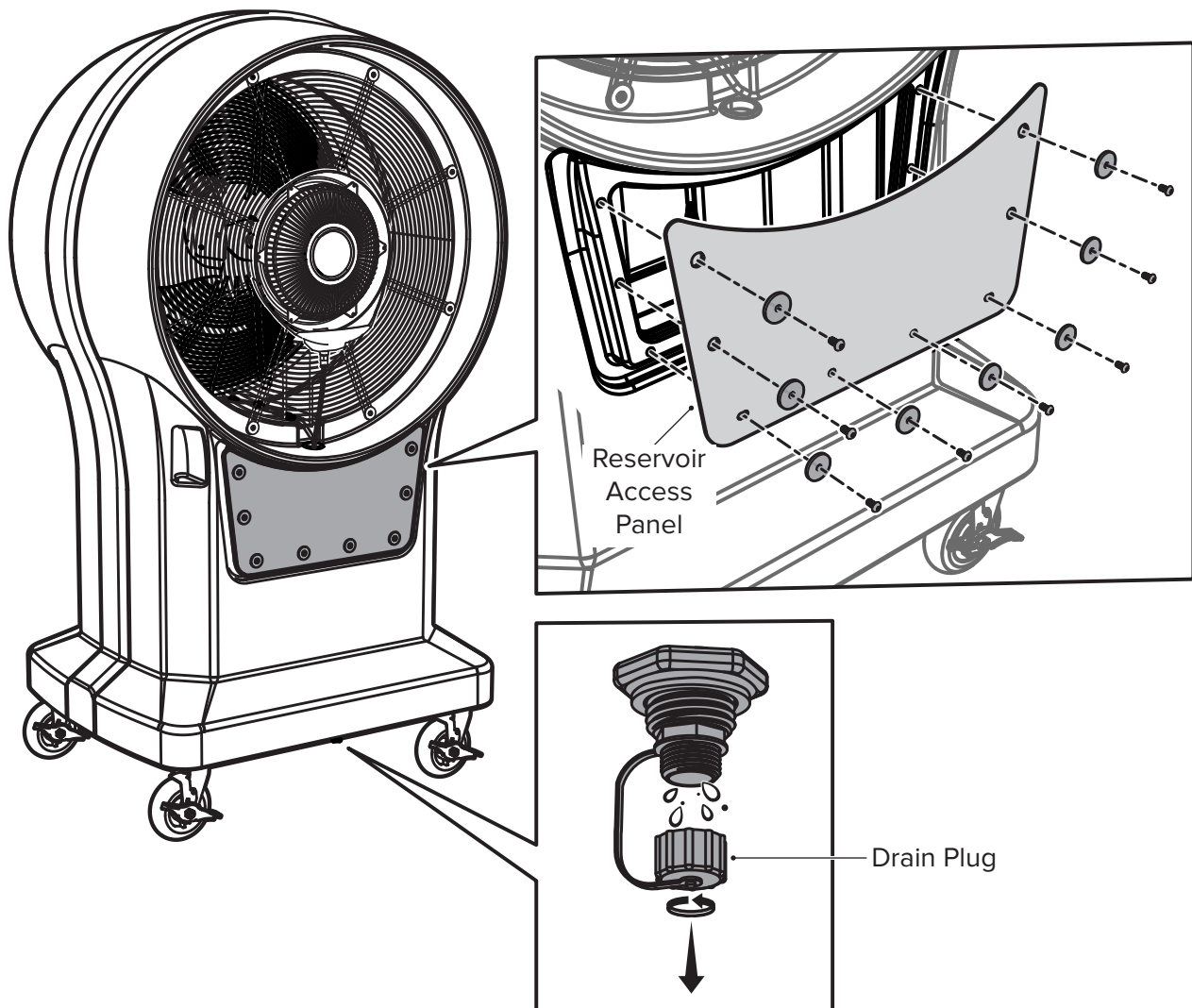

PUMP REPLACEMENT

2. Remove old pump assembly and filter bag

Locate pump assembly at bottom of reservoir. Note its location and orientation for installation of new pump assembly (Fig. 2.1). Carefully lift pump assembly out of access panel opening and allow to hang out of opening (Fig. 2.2). Cut zip tie securing filter bag around pump assembly. Remove filter bag and **discard**.

Disconnect water supply line from top of pump assembly by pushing in on line and then pulling line out of pump fitting (Fig. 2.3). Disconnect three-pin pump assembly wiring harness from three-pin wiring harness inside access panel opening (Fig. 2.4).

Fig. 2.1: Locate pump assembly



Fig. 2.2: Remove pump assembly



Fig. 2.3: Disconnect supply line

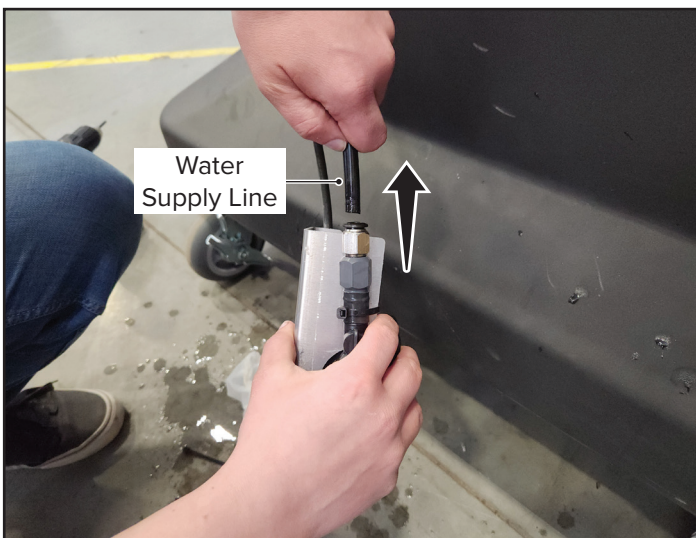
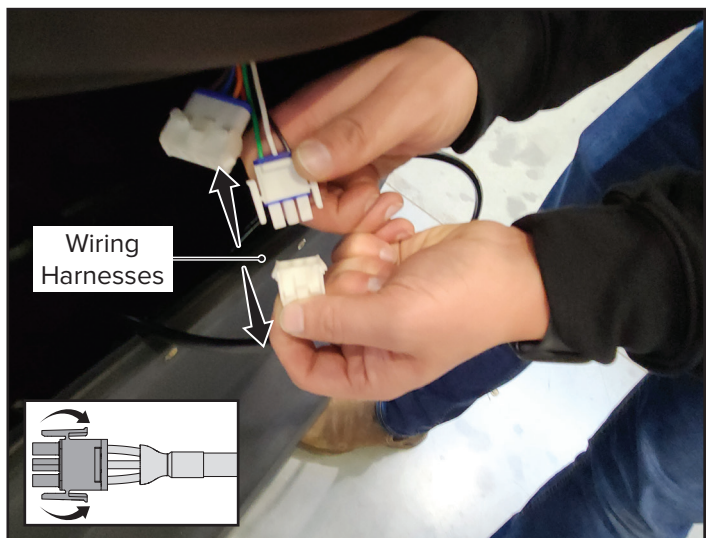

Fig. 2.4: Disconnect wiring harnesses



3. Install new pump assembly and filter bag

Rest new pump assembly on the ground next to unit. Connect three-pin pump assembly wiring harness to three-pin harness inside access panel opening (*Fig. 3.1*). Connect water supply line to new pump assembly by pushing line into fitting on top of pump (*Fig. 3.2*).

Secure provided new filter bag around pump assembly with a zip tie. Place pump assembly into reservoir in the location shown and make sure pump is sitting level (*Fig. 3.3*).

Fig. 3.1: Connect wiring harnesses

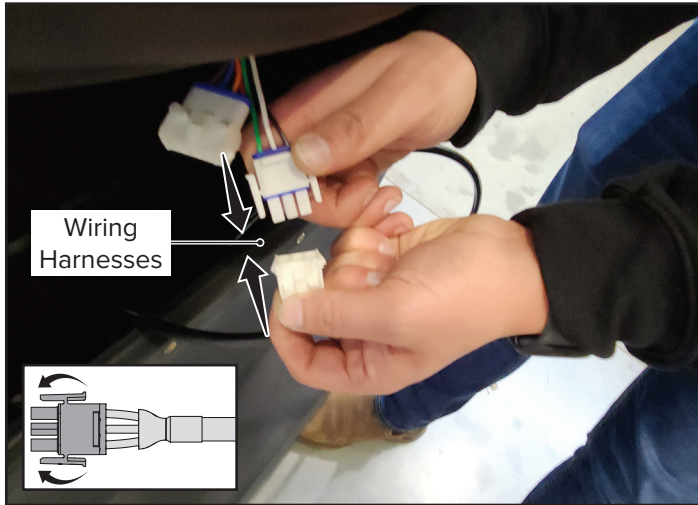

Fig. 3.2: Connect supply line

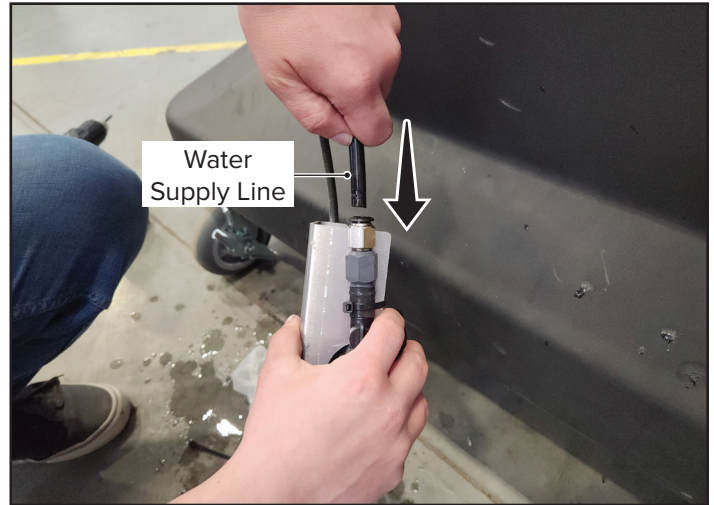

Fig. 3.3: Position pump assembly



PUMP REPLACEMENT

4. Reinstall access panel

Reinstall reservoir access panel and torque the eight screws to **30 in-lb (3.4 N·m)** (Fig. 4).

Fig. 4

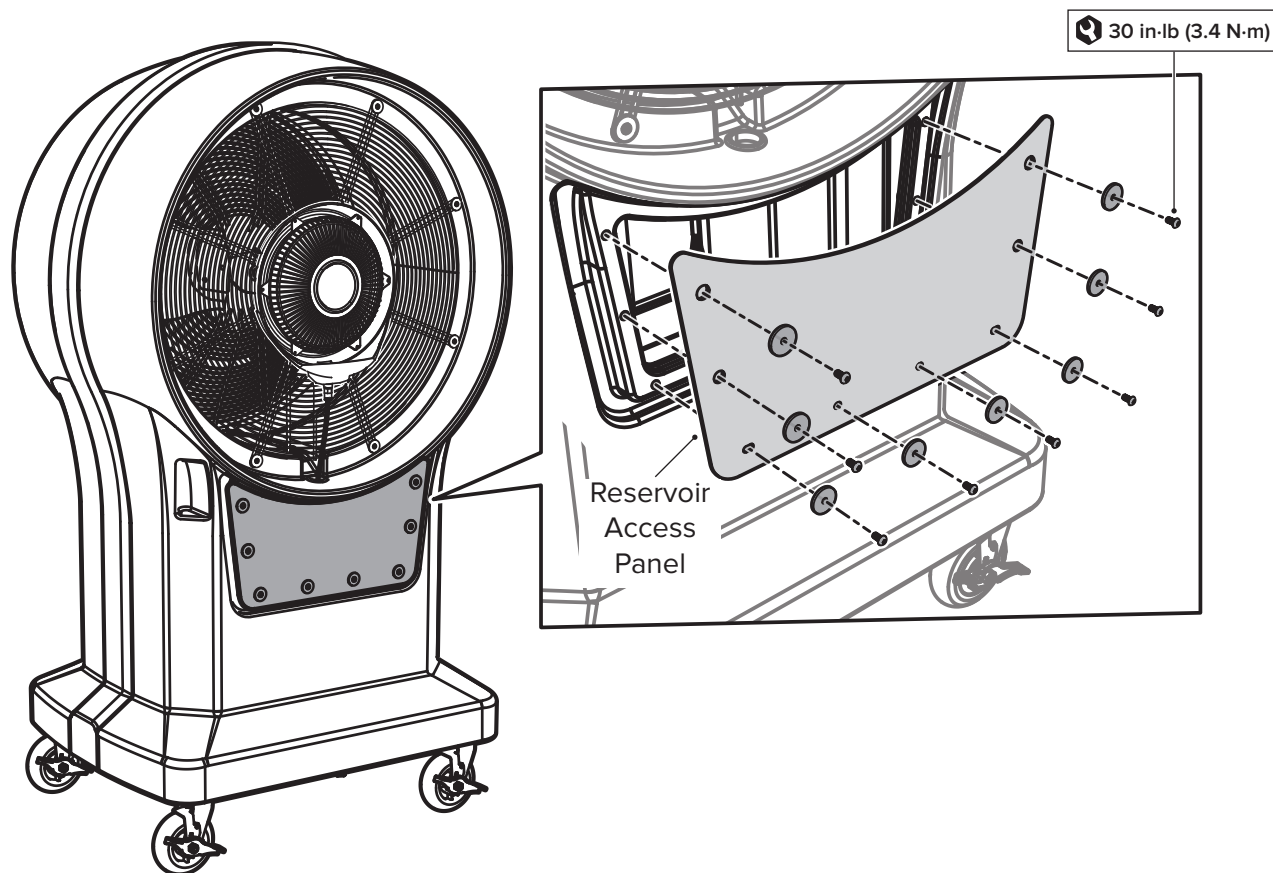

TOR-INST-465-MUL-01
Rev. A 03/13/2025